



MyEstate Woven Strand Bamboo Board - Installation

Summary

MyEstate Woven Strand Bamboo Board is supplied with grooved side edges and tongue and groove joints to allow seamless installation via hidden fixings.

Installation

1. Install to timber or steel battens/nogs/joists with a minimum spacing of 400mm and maximum spacing of 600mm centers.

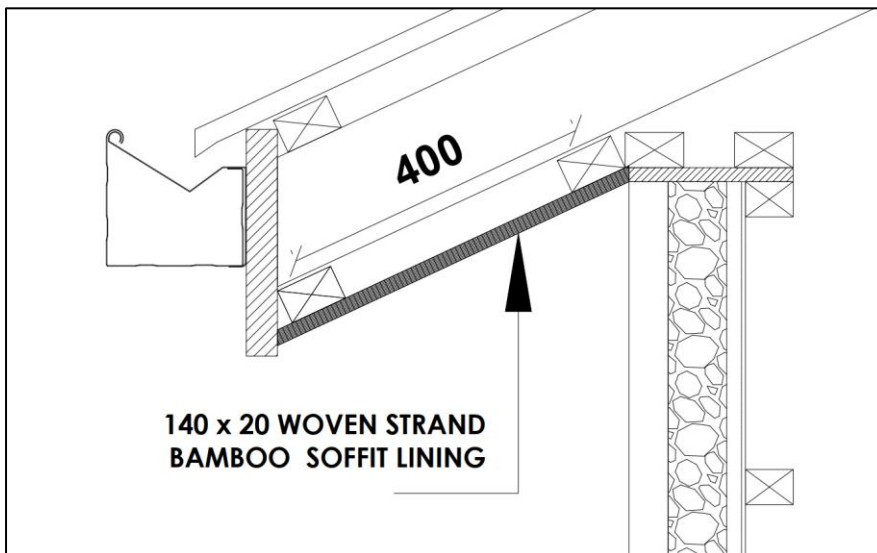

2. The first board is fixed with our “Starter Clip” hidden fixing. Screw the fixing in place, then slide the board hard up into the fixing, so the fixing lips grips the boards groove.



3. All subsequent boards are then fixed using our dual sided hidden fixing.
 - a. Slide the dual sided fixing hard up into the boards groove, so the fixing lips grips the boards groove.
 - b. Screw the fixing to the substrate. (2 holes go under the board, the single hole is used for fixing)
 - c. Insert the next board and push it hard up into the other side of the dual sided fixing.

